

## Horizontal Wall Post Indicator

### IP888W

Reference	Dimensions (mm / inch)			Weight (kg/lbs)
	A	B	C	
IP888W	508 / 20.0	432 / 17.0	356 / 14.0	45 / 99

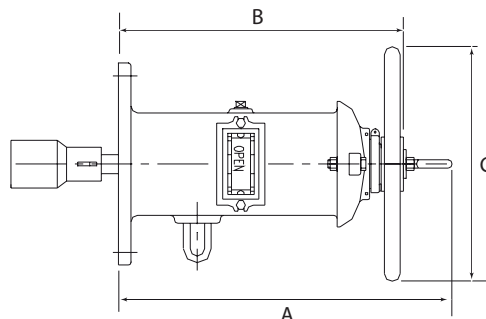

### IP888W

### Specifications

- Indicator of Open and Shut positions
- Used to operate a hidden valve
- 12" OD post flange for wall mounting
- Handwheel operation
- Right and left hand versions available
- Internally and externally coated in red epoxy resin RAL3000
- 1m long stem bar is supplied

### IP888W

### Materials List

Item	Description	Material	Specification
1	Eye Bolt	Carbon Steel	ASTM A307B
2	Hex Nut, 1/2"-13UNC	Carbon Steel	ASTM A307B
3	Washer	Carbon Steel	ASTM A570 Gr. 33
4	Handwheel	Ductile Iron	ASTM A536 65-45-12
5	Hex Bolt, 1/2"-13UNC	Carbon Steel	ASTM A307B
6	Hex Nut, 1/2"-13UNC	Carbon Steel	ASTM A307B
7	Snap Ring	Stainless Steel	AISI 1066
8	Cover	Cast Iron	ASTM A126B
9	Operating Nut	Bronze	ASTM B62 C83600
		Stainless Steel	AISI 304
10	Target Nut Carrier	Bronze	ASTM B62 C83600
		Stainless Steel	AISI 304
11	Window Glass	Plexiglass	
12	Gasket	PTFE	
13	Hex Bolt M8x85	Carbon Steel	ASTM A307B
14	Plug*	Malleable Iron	
15	Target	Cast Aluminium	
16	Hex Bolt M6x85	Carbon Steel	ASTM A307B
17	Hex Nut M6	Carbon Steel	ASTM A307B
18	Body	Cast Iron	ASTM A126B
19	Stem	Carbon Steel	AISI 1045
20	Crane Coupling	Ductile Iron	ASTM A536 65-45-12
21	Cotter Pin Ø 1/4"x3"	Stainless Steel	AISI 304

\* Not indicated

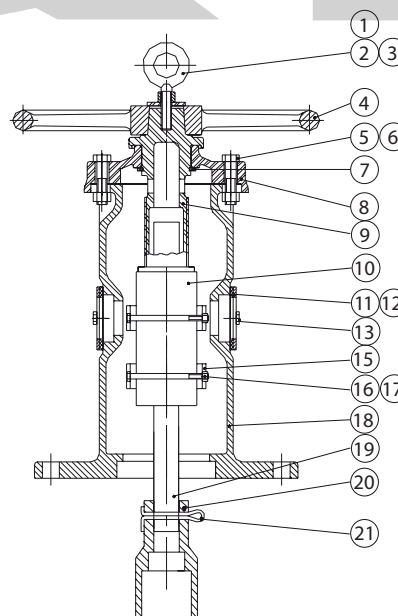
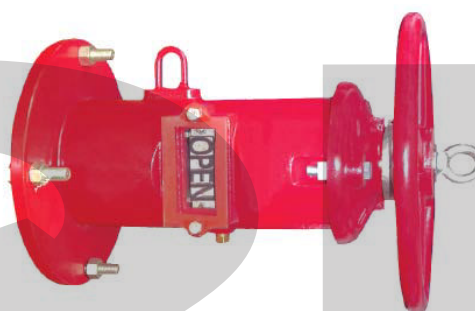

**Horizontal Wall Post Indicator**

IP888W

**Installation**

NOTE: Ensure that the non-rising stem gate valve is in the fully open position before installing the Wall Post Indicator.

**1.) Make the wall through hole**

Make a clearance hole that is at least 120mm (4.7") in diameter but not greater than 180mm (7.1") in diameter through the mounting wall. The clearance hole must be on-center and concentric with the operating nut of the non-rising stem gate valve. NOTE: A DN100 / 4" (114.3mm Outside Diameter) length of pipe can be used to line the inside of the through hole. Pipe of this diameter will fit snugly into a machined mating hole on the flange side the Body (18) of the Wall Post Indicator.

**2.) Drill the Mounting Holes**

Drill 4 equally spaced holes on a 267 mm (10.5") bolt circle into the mounting wall using a 3/4" (19mm) drill bit. The bolt circle must be concentric and on center with the operating nut of the non-rising stem gate valve.

**3.) Mount the Wall Post Indicator**

Bolt the flange of the Body (18) of the Wall Post Indicator to the wall using 4 bolts.

**4.) Remove the Cover**

With the Body (18) flange of the Wall Post Indicator securely bolted to the mounting wall, remove the Cover (8) by removing the two Bolts (5) and Nuts (6). Slide the Cover (8) off of the Wall Post Indicator Body (18).

**5.) Insert and measure the Stem Rod**

With the Cover (8) still separated from the Body (18), slide the Stem (19), Cotter Pin (21) and Crane Coupling (20) assembly through the Wall Post

Indicator Body (18) and through the wall such that the Crane Coupling (20) fully engages with the operating nut of the non-rising stem gate valve. With the Crane Coupling (20) fully engaged on the operating nut of the non-rising stem gate valve, put a mark on the Stem (19) that is between 1.25" (32mm) below the top surface of the Body (18) but not more than 2" (50mm) above the top surface of the Body (18).

**6.) Cut the Stem Rod**

Cut the stem rod at the mark made in Step 5.

**7.) Adjust the Target Plates**

Adjust the "Open" Target Plates (15) such that they are squarely centered in the Windows (11) when the non-rising stem valve is in the fully open position. Repeat this procedure with the "Shut" Target Plates (15) when the non-rising stem gate valve is fully closed. Adjustment is made is made by loosening Hex Bolt (16) and Nut (17).

**8.) Re-assemble the Wall Post Indicator**

Insert the Cover (8) back onto the Body (18) such that the ears on either side of the Target Nut (10) fit into the grooves on the inside edges of the Body (18). Tighten the two Nuts and Bolts (5)(6). Verify that the "Open" and "Shut" Target (15) is in the proper position by fully opening and closing the non-rising stem gate valve using the Handwheel (4). Adjust as necessary.

**Maintenance****Lubrication**

Oil the bearing in the Body (18) at least once a year by adding several drops of oil in the hole located on the top of the Operating Nut (9).