

# MANGUITO ELÁSTICO SIMPLE ONDA

## RUBBER EXPANSION JOINT, SINGLE SPHERE

ART. NUM: 5121

Materiales:

CUERPO EN EPDM CON REFUERZO INTERIOR	1
MALLA DE NYLON	2
ESTRUCTURA EN HILO METALICO DE ACERO	3
BRIDAS EN ACERO FORJADO CROMADO	4

Límites Técnicos:

PRESION NOMINAL DE TRABAJO: 1,6 Mpa (16 BAR)  
 PRESION DE ROTURA: 4,5 Mpa (45 BAR)  
 TEMPERATURA DE TRABAJO: -10°C - 80°C  
 PRESION AL VACIO: 100KPa (1 BAR)

Características:

DIMENSIONES BRIDAS BAJO NORMA DIN 2501

Components:

BODY IN POLARIZED RUBBER EPDM	1
LINING IN NYLON	2
FRAME IN HARD STEEL WIRE	3
FLANGE IN CHROMED FORGED STEEL	4

Technical Limits:

WORKING PRESSURE: 1,6 MPa (16 BAR)  
 BURSTING PRESSURE: 4,8MPa (48 BAR)  
 WORKING TEMPERATURE: -10°C - +80°C  
 VACUUM PRESSURE: 100 KPa (1 BAR)

Features:

FLANGES DRILLS SIZE ACCORDING TO DIN 2501

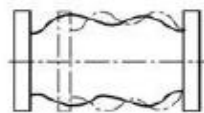
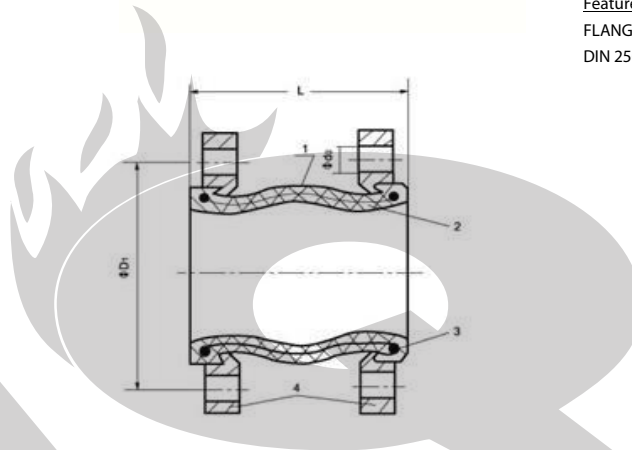

Axial Compression

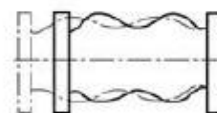

Axial Stretch

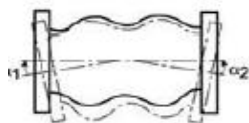

Angle Of Deflection

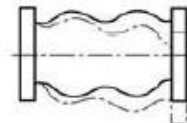

Lateral Displacement

Dimensiones / Sizes:

Axial Displacement/ Movimiento Axial

Art. No.	DN	L	n	d0	d1	Elongation (mm)	Compression (mm)	Lateral (mm)	Angle	Kgs
5121-040	40	95	4	17,5	110	6	10	9	15°	2,6
5121-050	50	105	4	17,5	125	7	10	10	15°	3,4
5121-065	65	115	4	17,5	145	7	13	11	15°	4,7
5121-080	80	130	8	17,5	160	8	15	12	15°	5,6
5121-100	100	135	8	17,5	180	10	19	13	15°	7,4
5121-125	125	165 160	8	17,5	210	12	20	14	15°	7,9
5121-150	150	180 185	8	22	240	12	25	22	15°	10,3
5121-200	200	210	8	22	295	16	25	22	15°	12,8
5121-250	250	230 240	12	22	350	16	25	22	15°	18,4

Utilización: Garantizada para el uso en agua fría y caliente, agua de mar, aire comprimido y ácidos débiles.  
 Use: Guaranteed for the use of cold and hot water, sea water, air compressed and weak acids.