



Revision Date: December,2013

RIGID COUPLING  
GKS

## Rigid Coupling

Rigid couplings are a standard rigid coupling for general piping applications where rigidity is required.

Sizes available: 1" ~ 10"

Working pressure: 300PSI/2.5MPA

### MATERIAL SPECIFICATIONS

- **Housing:**  
Ductile iron conform to ASTM A536 65-45-12
- **Coating:**
  - Dacromet (optional)
  - Red paint (RAL 3000)
- **Rubber gasket:**  
EPDM gaskets dispose of the international certifications and have undergone the aging test at 110°C (230°F) during a period of 45 days (1080 hours). Moreover, the gaskets have undergone the frozen test at -40°C (-40°F) during a period of 4 days (96 hours).
- **Bolts & Nuts:**  
Medium Carbon Steel

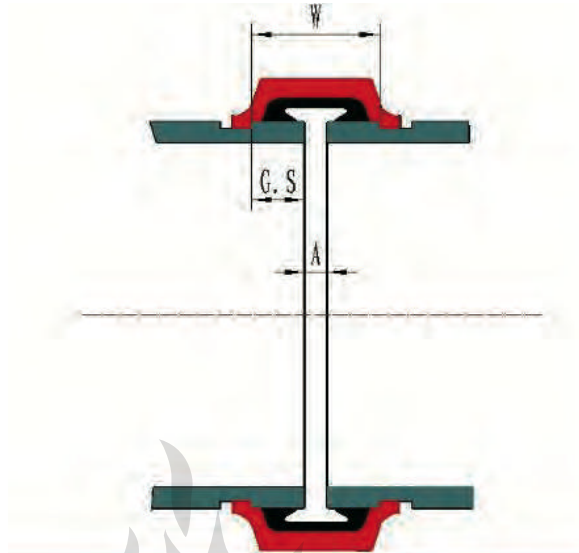

**GAP BETWEEN TWO PIPES**

Reference		Nominal Size		Actual Outside Dia. mm	W mm	G.S (mm)			Gap between two pipes (A) (mm)	
Red	Dacro	inches	mm			Basic	Max.	Min.	Max.	Min.
GKSR	GKSG	1"	25	33.7	34	15.88	16.64	15.12	1.58	0
GKSR	GKSG	1 ¼"	32	42.4	34	15.88	16.64	15.12	1.58	0
GKSR	GKSG	1 ½"	40	48.3	34	15.88	16.64	15.12	3.28	0.24
GKSR	GKSG	2"	50	60.3	35	15.88	16.64	15.12	2.18	0
GKSR	GKSG	2 ½"	65	76.1	35	15.88	16.64	15.12	1.48	0
GKSR	GKSG	3"	80	88.9	35	15.88	16.64	15.12	3.98	0.94
GKSR	GKSG	4"	100	114.3	36	15.88	16.64	15.12	2.18	0
GKSR	GKSG	5"	125	139.7	37	15.88	16.64	15.12	2.38	0
GKSR	GKSG	6"	150	168.3	38	15.88	16.64	15.12	2.38	0
GKSR	GKSG	8"	200	219.1	44	19.05	19.81	18.29	3.88	0.8
GKSR	GKSG	10"	250	273	47	19.05	19.81	18.29	7.38	0.7

- The actual Gap between the pipes maybe changed according to the actual Cut and roll Groove.

General notes:

- Pressure ratings listed are CWP(cold water pressure) or maximum working pressure within the service temperature range of the gasket used in the coupling. This rating may occasionally differ from maximum working pressure listed and/or approved by UL and/or FM as test working pressure listed and/or approved by UL and/or FM as testing conditions and test pipes differ.
- Maximum working pressures and end loads listed are total of internal and external pressures and loads based on standard weight (ANSI) steel pipe, standard roll or cut grooved accordance with LEDE specifications.
- For one time field test only the maximum joint working pressure may be increased 1-1/2 times the figure shown.
- Warning: piping systems must always be depressurized and drained before attempting disassembly and/or removal of any components.
- LEDE reserves the right to change specifications, designs and/or standard equipment without notice and without incurring any obligations.

**Dimensions**

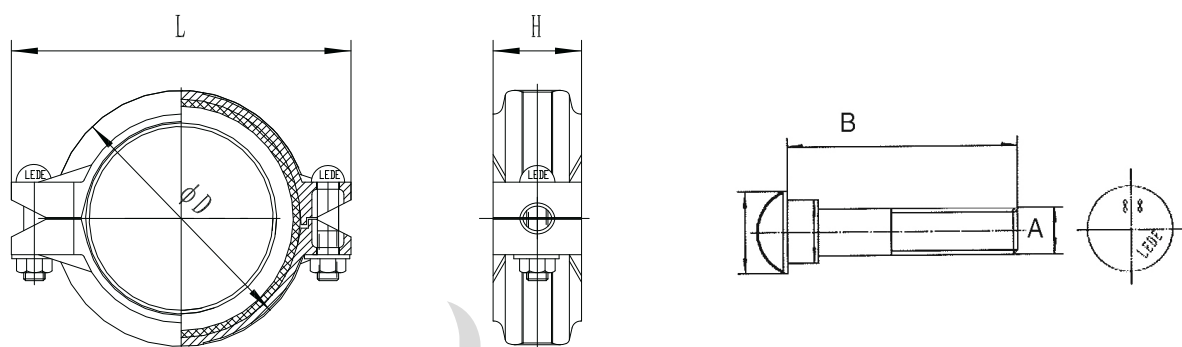

RIGID COUPLING  
GKS

Reference		Size Inch	Nominal Dimensions					Bolt Size Dia. X Lg. (A X B)	Bolt Torque N*M	Nuts mm	Socket wrench mm	Weight Kg
Red	Dacro		O.D. mm	DN mm	$\varnothing D$ mm	L mm	H mm					
GKSR	GKSG	1"	33.7	25	55	97	45	M10X40	75-80	21.8	15	0.42
GKSR	GKSG	1 1/4"	42.4	32	63.5	107.5	45	M10X50	75-80	21.8	15	0.51
GKSR	GKSG	1 1/2"	48.3	40	69	114	45	M10X50	75-80	21.8	15	0.54
GKSR	GKSG	2"	60.3	50	83.6	124	46	M10X60	75-80	21.8	15	0.67
GKSR	GKSG	2 1/2"	76.1	65	98	139	46	M10X60	75-80	21.8	15	0.80
GKSR	GKSG	3"	88.9	80	114	156	46	M10X60	75-80	21.8	15	0.96
GKSR	GKSG	4"	114.3	100	142	189	50	M12X70	125-140	26	18	1.40
GKSR	GKSG	5"	139.7	125	170	222	50	M12X70	125-140	26	18	1.75
GKSR	GKSG	6"	168.3	150	198	251	50	M12X70	125-140	26	18	1.97
GKSR	GKSG	8"	219.1	200	260	322	58	M16X85	200-230	34.5	24	3.86
GKSR	GKSG	10"	273	250	319	393	64	M20X110	270-300	42.8	30	6.22

General notes:

- Pressure ratings listed are CWP(cold water pressure) or maximum working pressure within the service temperature range of the gasket used in the coupling. This rating may occasionally differ from maximum working pressure listed and/or approved by UL and/or FM as test working pressure listed and/or approved by UL and/or FM as testing conditions and test pipes differ.
- Maximum working pressures and end loads listed are total of internal and external pressures and loads based on standard weight (ANSI) steel pipe, standard roll or cut grooved accordance with LEDE specifications.
- For one time field test only the maximum joint working pressure may be increased 1-1/2 times the figure shown.
- Warning: piping systems must always be depressurized and drained before attempting disassembly and/or removal of any components.
- LEDE reserves the right to change specifications, designs and/or standard equipment without notice and without incurring any obligations.